



HD Front Bumper, Polaris Sportsman® 1000 XP (17-22) Instructions

Removal

1. Using one of the supplied **hex bolts and ¼" spacer** as a template, mark the underside of the **lower front fascia** to be trimmed on both sides as pictured. *(See Figure #1)*

(See Figure #2)

2. Remove the **lower front fascia** marked in the previous step by removing the **(4) 13mm head bolts** holding it to the frame. *(See Figure #3)*

3. Trim the **lower front fascia** to as marked previously to allow for the bolt and spacer to be installed. *(See Figure #4)*

Installation

1. Reinstall the trimmed **front fascia** using the **factory hardware**.

2. Install the **skid plate** to the bumper using the provided **(4) M8 Speednuts, (4) M8x20 Button Head Allen Bolts, and (4) ¼" Flat Washers**.

Note: If you have purchased the Fairlead Skid Plate the fairlead should be installed using the appropriate hardware provided with it.

3. Open the **front storage compartment** and **remove the bin** to expose the battery and top of the radiator. Loosen the **(2) top radiator mounting bolts** found under the front storage compartment. Move the radiator upward slightly and slide the provided **(1) Sportsman Nut Bracket** into the factory bumper mounting tubes.

NOTE: Orient the Sportsman Nut Bracket as pictured. *(See Figure #5)*

(See Figure #6)









4. Tighten the top radiator mounting bolts and replace the front storage bin.

5. Loosely install the bumper starting with the lower mounting locations using the provided **(2) M8x65 Hex Bolts, (2) ¼" spacers, (4) ¼" Flat Washers, and (2) M8 Nylock Nuts**. Note: Place (1) Flat washer against the head of the bolt, the ¼" spacer will go between the bumper and the vehicle's frame, another washer at the top of the frame, and finally the nylock nut.



6. Loosely install the upper bumper mounting hardware using the provided **(2) M8x40 Hex Bolts, and remaining (2) ¼" Flat Washers**.

7. Check for proper alignment and clearance, then tighten all hardware. *(See Figure #7)*

Hardware

-  (1) 400080 - Allen Key
-  (4) 400031 - Bolt - Buttonhead - M8-1.25 X 20
-  (2) 400023 - Bolt - Hex - M8-1.25 X 40
-  (2) 400187 - Bolt - Hex - M8-1.25 X 65
-  (1) 400188 - Bracket - Nut - Polaris® Sportsman
-  (2) 400015 - Nut - Nylock - M8-1.25
-  (4) 400081 - Nut - Speed/Clip - M8-1.25
-  (1) 9345334561 - Skid Plate, Polaris®

Sportsman/Scrambler XP 850/1000

-  (2) 200059 - Spacer - 1/4 in Aluminum
-  (10) 400073 - Washer - Flat - 1/4"

* Click thumbnails to enlarge

Figure #1



Figure #2

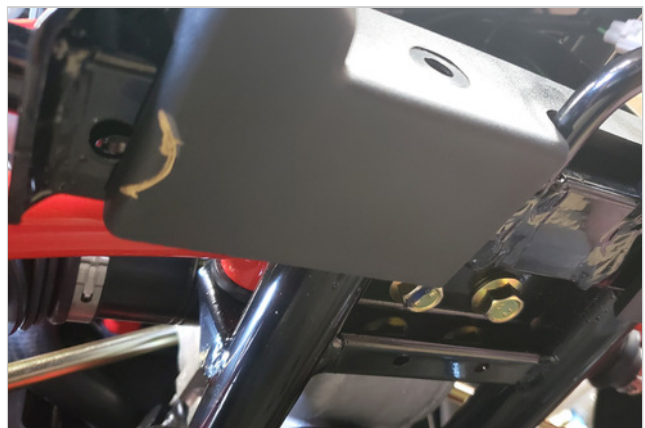

Figure #3



Figure #4

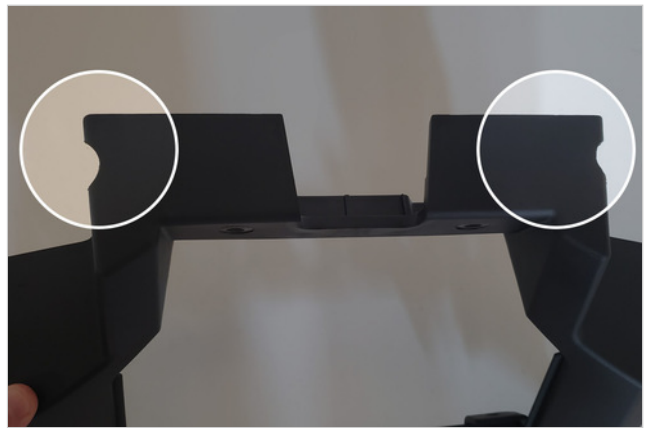

Figure #5

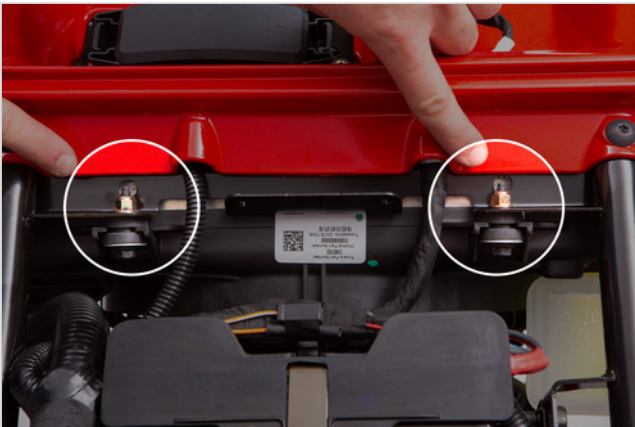

Figure #6



Figure #7



(1) Allen Key



(4) Bolt - Buttonhead - M8-1.25 X 20

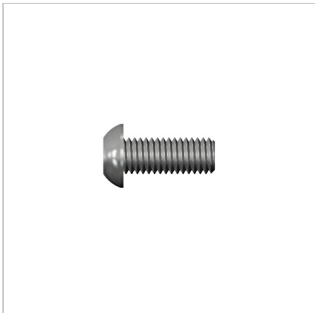

- (2) Bolt - Hex - M8-1.25 X 40
- (2) Bolt - Hex - M8-1.25 X 65
- (1) Bracket - Nut - Polaris® Sportsman
- (2) Nut - Nylock - M8-1.25

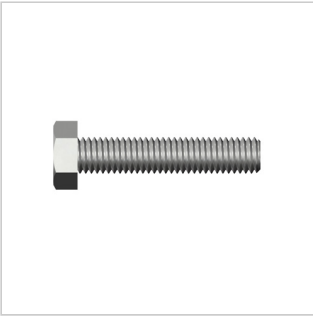

- (4) Nut - Speed/Clip - M8-1.25
- (1) Skid Plate, Polaris® Sportsman/Scrambler XP 850/1000
- (2) Spacer - 1/4 in Aluminum
- (10) Washer - Flat - 1/4"

